

ONSEN HYDROMASSAGE POOL

Part of the Myrtha Wellness collection created to excite and last thanks to the stainless-steel soul hidden under the timeless finishes.

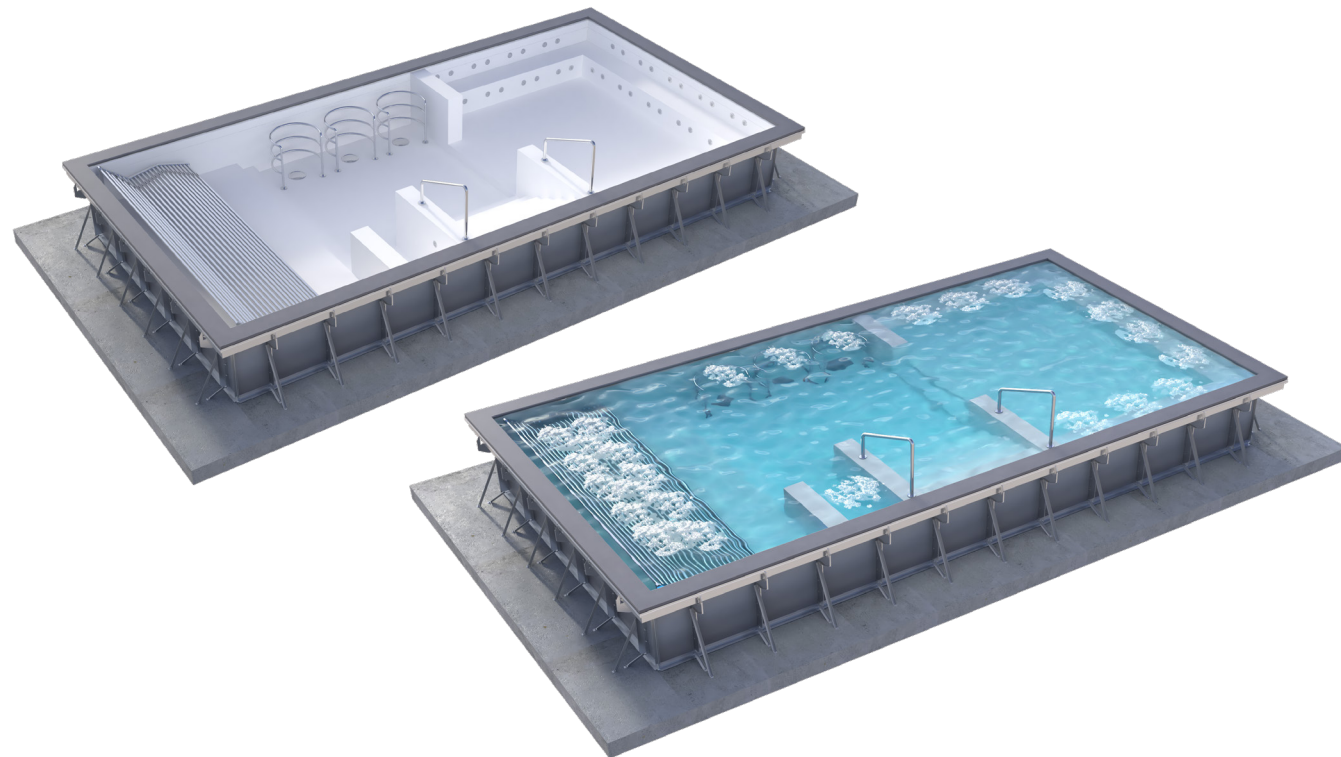

Product ONSEN HYDROMASSAGE POOL is CE certified, UL and SB certified versions are available upon request.

TECHNICAL DATA SHEET

STRUCTURE	<p>Myrtha pool wall construction with base frame, wall panels, overflow gutter and buttress system. Wall panels and overflow gutter made of stainless-steel laminated with a hard PVC composite material specified below. The hot polymerisation process gives a permanently bonded surface to the stainless-steel and the rear of the wall panels are covered with a transparent LDPE sheet for additional protection.</p> <p>All other structural components are made of high-quality corrosion resistance stainless-steel as specified below.</p> <p>The Myrtha structural overflow gutter is a patented gutter system whereby a special profile acts as the structural wall of the gutter and mosaic or tile provide the aesthetic finishing. The structure rests on a PVC support fixed to the Myrtha horizontal channel. The overflow gutter grid is made of PP, inclined by 5° and satisfies C-24° anti-slip class.</p> <p>Optional: hidden gutter finishing. PVC supports will be supplied to be installed into the structural gutter which support a stone or other material matching the pool deck. It includes an anti-turnover profile for further stability. no. 1 support every 60 cm approx. The finishing stone is not supplied by Myrtha.</p>
STAIR AND WALLS	<p>Modular structure made of high-density insulation material 350 kg/m³. The stair and the walls are levelled with cement mortar, waterproofed and ready to be covered. Ground fixing system with mechanical anchorage. External finish in rough mortar ready to be covered in liner.</p>
SYSTEM	<p>PVC wall inlet with stainless-steel front grid. Overflow gutter drain. Whirlpool wall accessories.</p> <p>Piezoelectric buttons for games activation. Bottom drain. Bypass predisposition for the heating (heat exchanger not included).</p> <p>Optional: Filtration system. Geyser system for loungers and for barrel. Whirlpool system. Level sensors. Automatic disinfection system. Electrical panel.</p>

DESIGN

MODEL	ONSEN
OVERFLOW TIPOLOGY	Gutter grid or hidden gutter on demand (finishing stone on demand).
COVERING OF INTERNAL WALLS	Walls in stainless-steel covered by Myrtha finishing. *Myrtha finishing colours: white, blue or black (stone/ceramic on demand).
BOTTOM AND STAIR COVERING	Reinforced anti-slip PVC membrane. Colours available: white, blue or black (stone/ceramic on demand).
STAIR	Stainless-steel or internal.
HYDROMASSAGE BENCH	Bench in polished stainless-steel (AISI 316L) with whirlpool wall inlet.
HYDROMASSAGE LOUNGER	Lounger in polished stainless-steel (AISI 316L) with air distribution pipe along the lounger.
HYDROMASSAGE BARREL	Barrel in polished stainless-steel (AISI 316L) with water/air distribution.
HANDHOLD	Handhold built into the bulkhead face, in AISI 316 stainless-steel mirror finishing.
LIGHTING	Wall white spot LED (LED RGB upon request).

*Item to be defined